

Procare MF Pate

Paste Skin Barrier (Karaya Gum+Citrus Pectin)

Instruction Manual

- Prior to use, carefully read the instruction manual so that you understand the product's features.
- Keep the instruction manual close at hand and read it again when needed.

You can contact us at
E-mail: inquiry@alcare.co.jp
Fax: +81-3-5611-7827
www.alcare.co.jp/e

How to use (1):

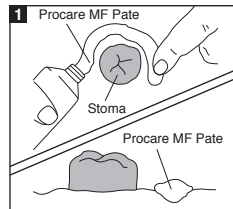

Apply the pate on the area with a wrinkle or dip.

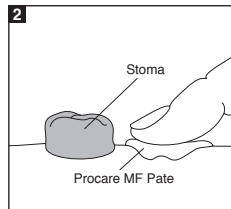

Flatten the skin surface. Apply the ostomy appliance as usual.

How to use (2):

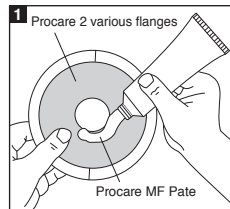

Apply a proper amount of pate around the hole made in the faceplate to fit to the stoma on the attachment side, and apply the faceplate to the skin.

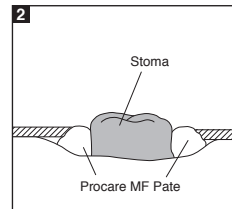

There is no need to wipe off any pate extruding from spaces.

Precautions for Use and Storage

To avoid peeling off or leakage due to decreased adhesive strength, observe the following:

- Use for the healthy skin only.
- Do not take a high-temperature bath too long time.
- Do not store in an area of high-temperature or high-humidity, or in a freezer.
- Keep out of reach of small children.
- Discontinue use if skin becomes irritated.

ALCARE

ALCARE Co., Ltd.

19F, Arcacentral Bldg., 1-2-1 Kinshi,
Sumida-ku, Tokyo, 130-0013, Japan
www.alcare.co.jp/e